



Gaia Starlight

400 IP20 22W/827-865 ACO WH

Gaia Starlight Surface mounted luminaire 22W
 2700-6500K 1600lm Dim depending on control gear;
 IP20; IK01; Protection cl. II; L70B50 30000h; LED not
 exchangeable; CRI>80; SDCM6; Suitable for through
 wiring; 3x2.5mm²; Housing Plastic; Colour wh; Cover
 Plastic, opal; C16 max. 11



400 IP20 22W/827-865 ACO WH			
PRODUCT CODE	CODE	KG	PRODUCT FAMILY
4245337	A2GASTA	0.94	Gaia Starlight

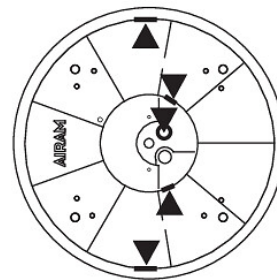
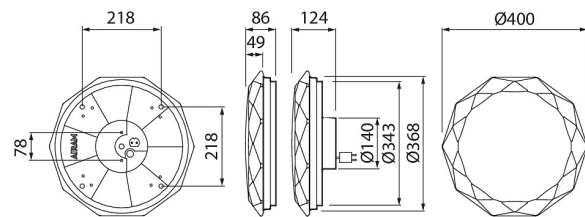

Mounting	
Suitable for wall mounting	Yes
Suitable for suspended mounting	No
Suitable for ceiling mounting	Yes
Suitable for recessed mounting	No
Suitable for surface mounting	Yes
Suitable for light line configuration	No
Fit for workplace acc. EN 12464-1	No
Degree of protection (IP)	IP20
Max. number of luminaires per miniature circuit breaker B16	11
Max. number of luminaires per miniature circuit breaker C16	11
Impact strength	IK01
Luminaire with limited surface temperature, class "D" in acc. with EN 60598-2-24	No
Suitable for emergency lighting	No
Type of wiring	Suitable for through wiring
Number of poles	3
Conductor cross section (mm ²)	2.5
Connection type	Screwless terminal
Quantity of luminaires for MCB C16:	11
Quantity of luminaires for MCB C10:	7
Quantity of luminaires for MCB B16:	11
Quantity of luminaires for MCB B10:	7
Structure	
Lamp type	LED not exchangeable
Light source included	Yes
Suitable for number of lamps	1
Lamp holder	Other
Housing material	Plastic
Housing surface protection	Plastic-coated
Housing colour	White
Cover material	Plastic, opal
Type of grid	White
Control gear included	Yes
Exchangeable control gear	Yes
Energy efficiency class of light source according to EU regulation 2019/2015	G
Emergency power supply integrated	No
With air slots	No
Filament test according to IEC 60695-2-11	650 °C - 30 s

Dimming and control	
Dimming 0-10 V	No
Dimming 1-10 V	No
Dimming DALI	No
Dimming DALI-2	No
Dimming DMX	No
Dimming DSI	No
Dimming LineSwitch	No
Dimming manufacturer's proprietary system	No
Dimming mains voltage modulation	No
Dimming trailing edge	No
Dimming leading edge	No
Dimming programmable	No
Dimming potentiometer (integrated)	No
Dimming RF	No
Dimming Sine Wave Reduction	No
Dimming Touch and Dim	No
Dimming Zigbee	No
Dimming with push-button	No
No dimming function	No
With movement sensor	No
With light sensor	No
Constant luminous flux control	No
Bluetooth operated	No
Compatible with Apple HomeKit	No
Compatible with Google Assistant	No
Compatible with Amazon Alexa	No
IFTTT support available	No
Photometric data	
Light distributor	None
Light sharing	Symmetric
Beam angle	Open beam
Colour consistency (McAdam ellipse)	SDCM6
Light outlet	Direct
Colour of light (alphanumeric)	White
Effective luminous flux (lm)	1600
Colour temperature (min) (K)	2700
Colour temperature (max) (K)	6500
Flickering value Pst LM	1
Colour rendering index (CRI/Ra)	80-89
Stroboscope effect value SVM	0.4
Photobiological safety according to EN 62471	RG0
Colour temperature switchable	Continuously variable
Lumen setting adjustable	Continuously variable
Beam angle adjustable	No
Lifetime and capacity	
Rated life time L70/B50 at 25 °C (h)	30000
Rated ambient temperature acc. IEC62722-2-1 (min) (°C)	0
Rated ambient temperature acc. IEC62722-2-1 (max) (°C)	25
Measurements	
Width (mm)	400
Height/depth (mm)	84
Length (mm)	400
Outer diameter (mm)	400

Electrotechnical data	
Voltage type	AC
Nominal voltage (min) (V)	220
Nominal voltage (max) (V)	240
Nominal current (min) (mA)	550
Nominal current (max) (mA)	550
Type of control gear	LED operating device current-controlled
Protection class according to IEC 61140	II
Suitable for lamp power (min) (W)	22
Suitable for lamp power (max) (W)	22
Maximum system power (W)	22
Luminaire efficacy (lm/W)	70
Power factor	0.9
Total harmonic distortion	20