

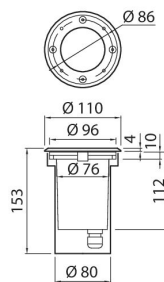

MALMI

MALMI IP67 GU10 MAX 35W ST

MALMI IP67 GU10 MAX 35W ST			
PRODUCT CODE	CODE	KG	PRODUCT FAMILY
4507304	A5ULCA	0.59	MALMI



Malmi
4507304

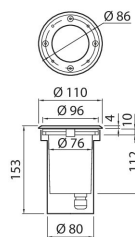

MALMI IP67 GU10 MAX 35W ST

EC000758

Mounting	
Degree of protection (IP)	IP67
Over rollable	No
Type of wiring	Ending
Number of poles	3
Conductor cross section (mm ²)	1.5
Connection type	Screwed terminal
Electrical connection with connector system	No

Structure	
Lamp type	LED exchangeable
Light source included	No
Suitable for number of lamps	1
Lamp holder	GU10
Housing material	Aluminium
Cover material	Glass transparent
Control gear included	No
Adjustable	No

Dimming and control	
Dimmable	No
Dimming 0-10 V	No
Dimming 1-10 V	No
Dimming DALI	No
Dimming DMX	No
Dimming DSI	No
Dimming LineSwitch	No
Dimming mains voltage modulation	No
Dimming trailing edge	No
Dimming leading edge	No
Dimming potentiometer (integrated)	No
Dimming programmable	No
Dimming RF	No
Dimming Sine Wave Reduction	No
Dimming Touch and Dim	No
Dimming with push-button	No
Dimming Zigbee	No
Constant luminous flux control	No
Compatible with Apple HomeKit	No
Compatible with Google Assistant	No
Compatible with Amazon Alexa	No
IFTTT support available	No

Photometric data	
Colour temperature switchable	No
Lumen setting adjustable	No
Beam angle adjustable	No

Lifetime and capacity

Measurements	
Width (mm)	110
Height/depth (mm)	153
Length (mm)	110
Outer diameter (mm)	110

Electrotechnical data	
Voltage type	AC
Nominal voltage (min) (V)	220
Nominal voltage (max) (V)	240
Type of control gear	Not required
Protection class according to IEC 61140	I
Suitable for lamp power (min) (W)	1
Suitable for lamp power (max) (W)	35